



Reo™

72" X 36" X 24" Oval Whirlpool and Bath



Model 5098 Shown

## Features

- 72" x 36" x 24" Oval Whirlpool and Bathtub
- Deep bathing well
- Hydro-V™ back jet system: Six jets massage the shoulder blades, upper and middle back muscles and the bottom two spinning jets for your lower back
- Swirl-way® jets adjustable in both direction and flow. Creates a broad, circular pattern of water and warm air for a deep venturi therapeutic massage.
- Cable operated drain in Color-Match, Chrome, Everbrass (PVD), Brushed Nickel and Oil Rubbed Bronze
- Powerful pump system creates an invigorating whirlpool action
- Dual air controls for the ultimate jet power control
- Trim finish in your choice of Color-Match, Chrome, Everbrass (PVD), Brushed Nickel and Oil Rubbed Bronze
- Outstanding protection — Mansfield® Limited Ten Year Warranty
- Available in Standard and Premium Colors  
(Consult Price Book for specific colors)

Organic design, clean lines, and intuitive function turn any bathroom into one's personal getaway spa. Featuring a deep bathing well with the Hydro-V™ back jet system with clean sharp lines and integral armrests. A fourteen jet system gives the bather all that's needed in hydro-massage therapy.

Model No.	Description	Approx. Wt.
5598	72" x 36" x 24" Oval bath. Specify color and options when ordering.	100 lbs. (45 kg)
5098BAS	72" x 36" x 24" Basic package oval whirlpool. Specify color and options when ordering.	125 lbs. (57 kg)
5098LUX	72" x 36" x 24" Luxury package oval whirlpool. Specify color and options when ordering.	125 lbs. (57 kg)
5098SEN	72" x 36" x 24" Sensory package oval whirlpool. Specify color and options when ordering.	125 lbs. (57 kg)

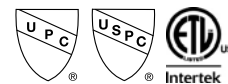

# Reo

72" X 36" X 24" Oval Whirlpool and Bath



## Features & Upgrades

### Basic Package

- SimpleTouch™ 3 button control
- Single speed pump
- Grab bars on selected models
- Pillows
- Color-match trim



### Luxury Package

- SensaSelect™ 5 button control
- Variable speed pump
- Remote control
- Grab bars on selected models
- Pillows
- Chromatherapy mood lights system
- In-line heater
- Metal trim upgrades

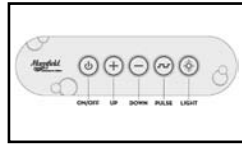

### Sensory Package

- SensaSelect™ 5 button control
- Variable speed pump
- PowerPillow™ neck jet pillow
- Remote control
- Grab bars on selected models
- Pillows
- Chromatherapy mood lights system
- Inline heater
- Metal trim upgrades

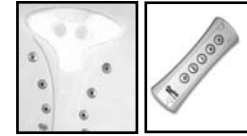
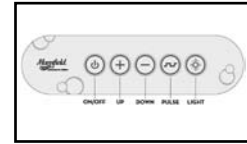

## Technical Information

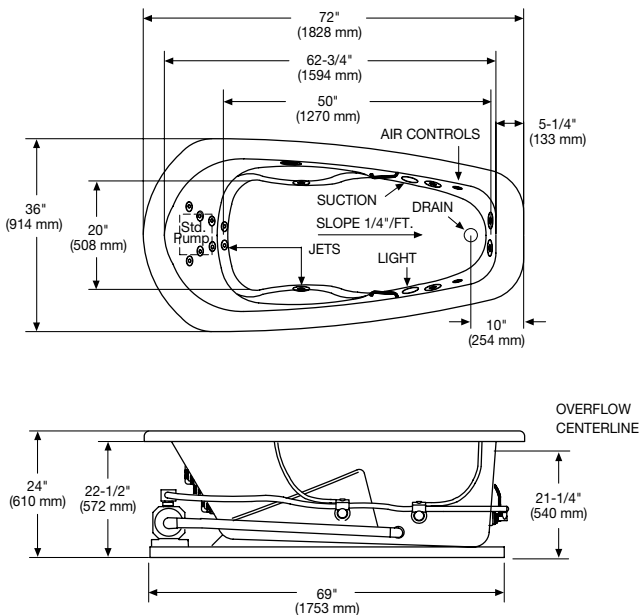

**No apron available on this model.**

Pump locations are shown for clarity.

**Note:** Install this product according to the installation guide.

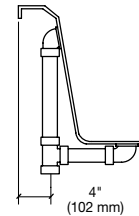
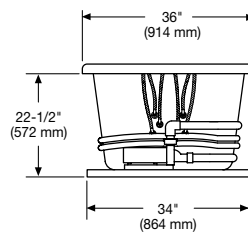

PLUMBING ROUGH-IN

Rough-in measurements may vary 1/4" (+/-)

INSTALLER NOTE: DUE TO THE FREEFORM SHAPE OF THIS TUB IT IS RECOMMENDED THAT THE TUB BE ON THE JOBSITE BEFORE MAKING THE FINAL CUT OUT FOR DROP IN INSTALLATION.

## Specifications

Dimensions	72" x 36" x 24"	Number of Jets	Fourteen
Material	Acrylic, fiberglass reinforced	Air Volume Control	Two
Construction	Self-contained, pre-plumbed whirlpool bath with heat-bent rigid PVC pipe, mounted on a pre-leveled base	Water Capacity	80 gal. max., 65 gal. min. (303 liters/246 liters)
Pump Motor	Single or variable speed, 120 volt, 60 HZ, 12.5 amps, single phase premounted	Floor Loading	47 lbs./sq. ft. (229 kg/m <sup>2</sup> )
Electrical Requirements	Lux.-Sen.: Two separate 120 volt, 20 AMP, GFCI protected circuits Basic: One separate, 120 volt, 20 AMP, GFCI outlet	Shipping Weight (whirlpool)	175 lbs. (80 kg)
		Shipping Weight (bath)	150 lbs. (68 kg)
		Warranty	Limited Ten Year

These dimensions are nominal and subject to change without notice.

When tested for compliance to the requirements of ANSI A112.19.7M for "Whirlpool Bath Appliances" and ANSI Z124.1.2M "American National Standard for Plastic Bathtub and Shower Units", the tested units are found to comply and are acceptable for listing under IAPMO R & T.

Certified for permanent electrical connection only.

Form No. M5098 Printed in U.S.A. 1/10  
© 2010 Mansfield Plumbing Products, LLC

® Swirl-way is a registered trademark of Mansfield Plumbing Products, LLC.



Mansfield Plumbing Products LLC • Customer Service Toll Free 800-999-1459 • Fax 903-655-3503  
Website: [www.mansfieldplumbing.com](http://www.mansfieldplumbing.com) • Email: [custserv@mansfieldplumbing.com](mailto:custserv@mansfieldplumbing.com)